

# **finetune**

---

Professional Audio Video Manufacturer

## **Wi-Fi Wireless Conference System**

**PRODUCT DATASHEET**



**Finetune Pro-Audio Inc.**

**Audio Intelligence**

## Application diagram

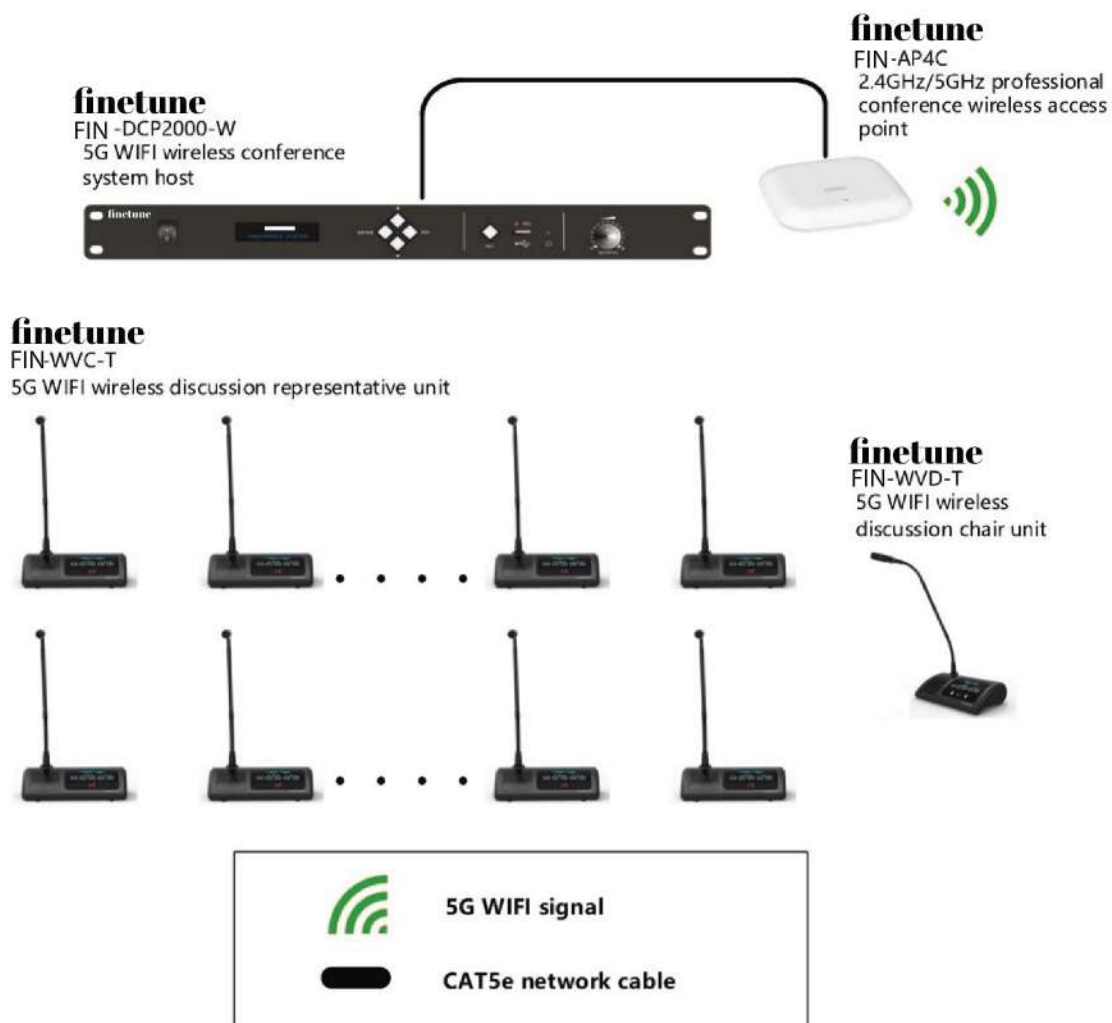

# finetune

Full Digital Networked DSP Conference System

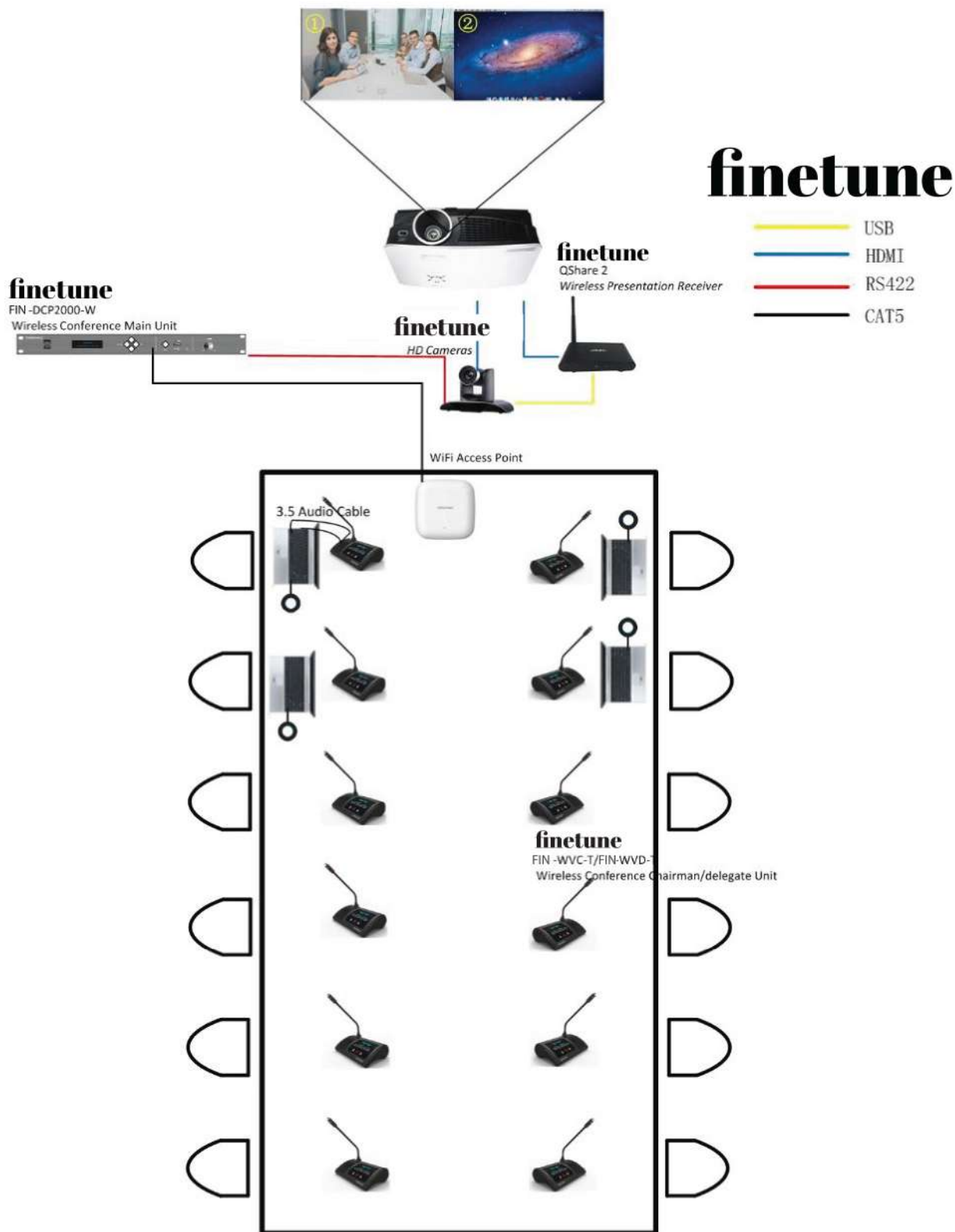

# New Generation **5GHz Wi-Fi** **Wireless** Conference System, with High Tech in DSP unique Sound Processing

## **PROCON 5GHz Wi-Fi Wireless Conference System**

### **Standard Wi-Fi Communication**

Our procon wireless conference system is an innovative system based on standard Wi-Fi technology and self-adjustment technology. The system work in the 2.4Hz and 5GHz band and get the 44 channels for communication to coexist with other Wi-Fi network. The unique self-adaptive technology is strong anti-interference ability ensure the system interference-free and highly flexible for different application. The standard Wi-Fi Technology make the system can work in around the world and no ISM limit.

### **Ease of Use**

The system is no additional cabling and testing and run under the 25-meter radius of Wi-Fi signal which is full 360-degree coverage. All microphone units automatically identify the access point and communicate with WPA2 secure connection to ensure the conferencing safety.

### **Compact yet versatile design**

The product design reflects the elegant, yet compact and easy to use features. Conference unit features a graphical interface operating area, including lighting reminder, anyone can get started quickly. Easy to install, user-friendly to use, and is designed to ensure higher productive meetings.

### **Excellent legibility sound**

Advanced voice processing technology, with the unique design of the microphone head, this unit can be accurate pickup and restore the human voice through a high-quality built-in speakers or an external PA system, original AUDIO-LINK digital ring network technology, Automatic Gain Control Volume(AGC) / automatic frequency control(AFC) technology help reach higher volume without triggering the howling effect, ensures clear sound to every person in the room.

### **High tech intelligence platform**

Timing function, overtime speaking reminder, voting results multi-platform synchronization, network control and meeting management, conference Smart reservation, worldwide firmware real-time updates, the integration of IT technologies ensures smart conferencing platform, the procon is one of them.

## FIN-DCP2000-W

Full Digital Networked DSP Conference Processor



### Features

- The unique AUDIO-LINK digital ring network technology achieve full-digital signal transmission and processing
- One CAT5e cable to transmit up 64 channels audio and other signals.
- All microphone units support audio, ID independent output. Working with voice recognition system to achieve voice role separation.
- High-fidelity sound quality by lossless audio transmission technology, 48K audio sampling rate and 20Hz ~ 20KHz frequency response
- A single conference controller can realize the independent control and merging of 4 conference rooms, can handle the cascade of multiple conference controllers to realize the merging and separation of larger conference rooms (Optional).
- "Hand-in-Hand-Loop-Network" connection makes the system always working perfectly no matter changing discussion unit or having any malfunctioned units
- The sensitivity of the unit microphone and 8 segment equalizer EQ adjusted independently.
- Conference controller can output 16 segment equalized EQ to achieve sound field adjustment; pressure limit, which can recognize the noise gate passed by human voice. AGC automatic volume gain control; AFC automatic feedback suppression and auto-mix technology.
- Sound output by separated zones function, each zone is automatically adjusted according to the volume of the position of the microphone, achieve longer distances pickup without whistle.
- Echo cancellation, remote two-way real-time call with another conference controller or another third-party video conferencing terminal.
- USB recording, controller monitor, advanced noise cancellation technology to realize clearer recording.
- System date, time management, and support count-down speech.
- Optional DANTE output module with other DANTE equipment used.
- Can drive 2x120W POE speaker, through extension main unit, support up to 16 POE speakers.

### Functions

- Compliance with IEC 60914, GBT 15381-94
- Connect with FIN-EXM full-digital extension main unit, it can expand to 5200 discussion units
- "Hand-in-Hand-Loop-Network" connection and the system assigned to each unit independently ID to avoid ID conflict.

- Both wired/wireless discussion units can connect to the controller, fast and easily to adding delegate of meetings.
- Up to 8 wireless microphones to be turned on at the same time, adaptive avoiding interference technology to achieve stronger anti-interference ability, compliance with IEEE 802.11n standard Wi-Fi both for 2.4GHz and 5GHz.
- 2 channel audio input, XLR or RCA type, for local audio input or remote video-conferencing input.
- Maximum 8-channel audio output, XLR, RCA or Phoenix type, can be connected to simultaneous interpretation output or partitioned output.
- Add the audio input box, the system can be connected to other condenser microphones or dynamic microphones, more choices for users.
- Built-in multi-way internal communication function.
- TCP/IP connection between controller and PC
- RS232 central control, realize microphone switch, priority, volume and other controls.
- RS232 or RS485 to send the PELCO/FINCA protocol to realize camera auto-tracking function.
- Hot plug-and-play, and auto-recovery function.
- Wide range of voltage from 100V~240VAC
- Without using PC software, our conference controller still owns following settings:
  - Limit on the number of speaking persons: By Setting the number of active units at the same time (Number is 1/2/4/6/ units), supports up to open 32 wired microphones in full-on mode.
  - Discussion modes:
    - "OPEN" Free for all, limited by the active units setting by controller, "VOICE" Can activate MIC by detecting sound without press button, "OVERRIDE" First in First out, "APPLY" To apply then to speak, "PTT" Press to speak(Optional),"ALL" Full open mode(Optional).
    - Voting function: Approve/Abstain/Object
    - Chairman unit has priority to close all other units or mute them temporarily
    - Chairman unit can consent the application for speaking from delegate
    - Simultaneous language interpretation
- With PC software to add more ways of voting:
  - Approve/Object
  - Approve/Abstain/Object
  - Level: 1/2/3/4/5
  - Ranking: --/0/+/++
- By using RFID card to identify, can realize voting with names.

## *Control & Indicators*

LCD display to show all the operations and results

4-Way button for menu operate

One-button press to start recording

light indicator

Master volume control knob

## *Interfaces*

Front panel USB recording interface

3.5mm headphone for monitoring  
1x RCA audio input  
1x XLR audio input  
1x RCA audio output  
1x XLR audio output  
6x Phoenix audio output connector  
2x RJ45 digital audio connection  
2x RJ45 for chairman unit, delegate unit, unit translators and other connection  
1x RJ45 for wireless AP or router  
1x DP9 male interface for external control  
1x DP9 female interface for camera  
1x three-pin phoenix interface for camera control keyboard  
1x RJ45 for computer connection or network switcher  
1x grounding screw  
1x 100 ~ 240V AC Power Interface

## *Technical Parameters*

Power 100V / 240V AC  
Static power consumption 12W  
Maximum power consumption 150W  
Frequency Response 20Hz ~ 20KHz  
Noise ratio (S / N) >96dBA  
Total harmonic distortion <0.05%  
Channel Crosstalk > 85dB  
Dynamic range >94dB  
RS-232 control: 1×9-pole Sub-D female socket 1×9-pole Sub-D male socket  
Ethernet control: RJ45 connected to PC  
Mounting: 19" standard rack  
Dimensions (mm) 483L x 260W x43.6H  
Weight: 3kg  
Black color

Max. audio inputs  
LINE IN 1: +10dBu  
LINE IN 2: +10dBu  
Max. audio outputs  
LINE OUT 1: +12dBu BAL.  
LINE OUT 2: +12dBu BAL.  
LINE OUT 3: +12dBu BAL.  
LINE OUT 4: +12dBu BAL.

Transmission technology: WIFI 802.1n  
Encryption technology: WPA2-PSK AES  
Page 7

Working frequency: 5.1-5.8 GHZ

Output impedance:  $>1k\Omega$

PC communication method: TCP/IP

Camera control method: RS-232/UDP

Network Interface: RJ45

Display: LCD1602

Limit on the number of speakers: 1/2/4, max in 6 persons

Camera Tracking Protocol: PELCO-P/PELCO-D/FINCA

Operating temperature: 0 ~ 45°C

Storage temperature: 20 ~ 50°C

### *Item Model for Order*

FIN-DCP2000-W..... Full digital network DSP conference processor



## PROCON Series FIN - WDC - T/ FIN - WDD - T

Wireless Digital Discussion Chairman/Delegate Unit



### Features

- Stylish, low profile design with touchable interface
- Wireless communication, setting up all system in few minutes to be ready for using, and put them away in short time as well
- Built-in DC connector for power supply without battery
- Detachable battery pack is easy to replace and charge, 4 hours to fully charged. Can use 24 hours continuously
- Internal high-fidelity loudspeaker
- Pluggable microphone and long range sound pickup ability, support different length of microphone.
- 2.23-inch OLED display with backlight, with status of signal and battery indication icon
- Head-set interface in both sides with volume adjust
- Line-in interface which allows microphone or other line-in device like cell phone, laptop to pass audio through to perform teleconference
- Full-digital signal transmission and processing, completely avoid the RF interference from cell phone or similar devices.
- The unit showing time/date on the screen. Timer on display to set certain time for each delegate to speak, will remind user or close the MIC automatically.
- All units can be configured as Chairman or Delegate unit through software settings based on mode FIN-WDC -T.

## Functions

- Compliance with IEC 60914, GBT 15381-94
- Standard Wi-Fi technology is compatible with other Wi-Fi networks, support 2.4GHz and 5GHz on all channels.
- Full-digital transmission and processing technology in uncompressed audio, professional microphone to achieve perfect sound quality at 20Hz ~ 20KHz;
- 128 bits digital encryption technology, with WAP2 secure connection, MAC address filtering, SSID-hiding to prevent wiretapping and unauthorized access from delegate unit
- 8 units of delegates can open at the same time
- Support more AP working together to increasing the Wi-Fi coverage range for wireless MIC units working in a large conference room or multi-rooms
- With our HD PTZ camera and video matrix switcher, using RS485 or RS232 protocol to send the PELCO/FINCA protocol to realize camera auto-tracking function
- Precise cardioid directional microphone capsule with anti-wind microphone foam, with two-color LED indicator
- Button for MIC ON/OFF, Priority & Apply Answer button for chairman unit
- Built-in high-fidelity speakers, it automatically mutes to prevent howling when press MIC ON
- Head-set interface in both sides with volume adjustment.
- AGC (Automatic Gain Control)/AFC (Adaptive Feedback Cancellation)/ANC (Active Noise Control)/Mix (Auto-Mix) technology
- Build-in functions for intercom
- Without using PC software, our conference controller still owns following settings:
  - Limit on the number of speaking persons: By Setting the number of active units at the same time (Number is 1/2/4/6/ units)
  - Discussion modes:  
"OPEN" Free for all, limited by the active units setting by controller, "OVERRIDE" First in First out, "VOICE" Can activate MIC by detecting sound without press button, "APPLY" To apply then to speak
- The unit showing real time on the screen, and count-down timer for speaking person.
- Detachable battery pack is easy to replace and charge, 4 hours to fully charged. Can use 24 hours continuously, power-saving technology to enable 24 hours continuous use and 48 hours for standby.
- Combined with camera and camera tracking controller, it has an automatic camera tracking function.
- With 2.5mm adapter power supply interface, used for emergency power supply.
- Built-in MCU, support wireless upgrade of all units.
- With voice control function, you can adjust the sensitivity of voice control, intelligently turn on the microphone and set the off time.

## Control & Indicators

Microphone with two-color LED ring, red indicates speaking status, green indicates request to speak. 128x32 OLED display with volume bar, clock, time span of microphone activating, MIC ON/OFF etc. and other information.

Indicator for Volume adjustment

Indicator for MIC ON/OFF

Page 10

Chairman unit with priority button and consent button for the delegates

Power ON/OFF button is hiding on the left side

## *Interfaces*

Pluggable gooseneck microphone base

2x 3.5mm stereo headphone jack

1x 3.5mm stereo input jack

Contact for battery pack

DC Connector for power adaptor

Echo cancellation built in support

## *Technical Parameters*

Button: Touchable interface

Sound Pickup: heart type capacitance / Cardioid Microphone

Display: OLED display 128 × 32

Sensitivity: -46 dBV / Pa

Maximum power consumption: 2.0W

Directivity: 0 ° / 180 ° > 20 dB (1 kHz)

Headphone load: 16Ω

Headphone volume: 10mW

Headphone jack: 3.5mm stereo

Input impedance: 2kΩ

SNR: 70dB

Frequency response: 20 ~ 20000Hz

Equivalent noise: 20dBA (SPL)

Main material: ABS

Operating temperature: 0 °C to + 55 °C

Color: Black

The maximum sound pressure: 125dB (THD ≤0.01%)

Weight: 1.1kg (with microphone)

Dimension: 195L × 120W × 60Hmm (without microphone)

Audio quality: 16 bit/48kHz support

## *Item Model for Order*

FIN -WDC-T..... Wireless Discussion Chairman unit, battery and microphone are not included

FIN -WDD-T..... Wireless Discussion Delegate unit, battery and microphone are not included

FIN -WBTY1..... Battery pack for each unit, 8.4VDC, 6600mA

FIN -WCH1..... Charger for battery

FIN -M220..... Pluggable Gooseneck Microphone 220mm, unique design

FIN -M330..... 330mm Microphone, with anti-wind foam cover

FIN -M410..... 410mm Microphone, with anti-wind foam cover

FIN -M485..... 485mm Microphone, with anti-wind foam cover

FIN -M600..... 600mm Microphone, with anti-wind foam cover

## PROCON Series FIN - WVC - T/ FIN - WVD - T

Wireless Digital Discussion+Voting Chairman/Delegate Unit



### Features

- Stylish, low profile design with touchable interface
- Wireless communication, setting up all system in few minutes to be ready for using, and put them away in short time as well
- 5 buttons for voting and ranking.
- Detachable battery pack is easy to replace and charge, 4 hours to fully charged. Can use 24 hours continuously, working time is 24 hours, 40 hours for standby
- Built-in DC connector for power supply without battery
- Internal high-fidelity loudspeaker
- built-in up 3 channels interpretation (optional on another model)
- Pluggable microphone and long-range sound pickup ability, support different length of microphone.
- 2.23-inch OLED display with backlight, with status of signal and battery indication icon
- Head-set interface in both sides with volume adjust
- Line-in interface which allows microphone or other line-in device like cell phone, laptop to pass audio through to perform teleconference
- Full-digital signal transmission and processing, completely avoid the RF interference from cell phone or similar devices.
- The unit showing time/date on the screen. Timer on display to set certain time for each delegate to speak, will remind user or close the MIC automatically.
- All units can be configured as Chairman or Delegate unit through software settings based on mode FIN-WVC -T.

### Functions

- Compliance with IEC 60914, GBT 15381-94
- Standard Wi-Fi technology is compatible with other Wi-Fi networks, support 5GHz on all channels.
- Full-digital transmission and processing technology in uncompressed audio, professional microphone to achieve perfect sound quality at 20Hz ~ 20KHz;
- 128 bits digital encryption technology, with WAP2 secure connection, MAC address filtering, SSID-hiding to

prevent wiretapping and unauthorized access from delegate unit

- 8 units of delegates can open at the same time
- Support more AP working together to increasing the Wi-Fi coverage range for wireless MIC units working in a large conference room or multi-rooms
- With our HD camera and video matrix switcher, using RS485 or RS232 protocol to send the PELCO/FINCA protocol to realize camera auto-tracking function
- Precise cardioid directional microphone capsule with anti-wind microphone foam, with two-color LED indicator.
- 5 voting buttons and 1 MIC ON/OFF button, Priority & Apply Answer button for chairman unit
- Built-in high-fidelity speakers, it automatically mutes to prevent howling when press MIC ON
- Head-set interface in both sides with volume adjust
- AGC (Automatic Gain Control)/AFC (Adaptive Feedback Cancellation)/ANC (Active Noise Control)/Mix (Auto-Mix) technology
- Build-in functions for intercom
- Without using PC software, our conference controller still owns following settings:
  - Limit on the number of speaking persons: By Setting the number of active units at the same time (Number is 1/2/4/6/ units)
  - Discussion modes:  
"OPEN" Free for all, limited by the active units setting by controller, "OVERRIDE" First in First out, "VOICE" Can activate MIC by detecting sound without press button, "APPLY" To apply then to speak
    - Voting function: Approve/Abstain/Object
    - Chairman unit has priority to close all other units or mute them temporarily
    - Chairman unit can consent the request for speaking from delegate
- More voting functions available by PC software
- The unit showing real time on the screen, and count-down timer for speaking person.
- Detachable battery pack is easy to replace and charge, 4 hours to fully charged. Can use 24 hours continuously, power-saving technology to enable 24 hours continuous use and 48 hours for standby
- Combined with camera and camera tracking controller, it has an automatic camera tracking function.
- With 2.5mm adapter power supply interface, used for emergency power supply.
- Built-in MCU, support wireless upgrade of all units.
- With voice control function, you can adjust the sensitivity of voice control, intelligently turn on the microphone and set the off time.

## Control & Indicators

**Microphone with two-color LED ring, red indicates speaking status, green indicates request to speak.**

128x32 OLED display with volume bar, clock, time span of microphone activating, MIC ON/OFF etc. and other information.

Indicator for Volume adjustment

5 voting keys with indicators, while no launching voting, no.2 and no.3 button is also work as channel selecting buttons, no.4 and no.5 work as volume buttons.

Indicator for MIC ON/OFF

Chairman unit with priority button and consent button for the delegates

Power ON/OFF button is hiding on the left side

## *Interfaces*

Pluggable gooseneck microphone base  
2x 3.5mm stereo headphone jack  
1x 3.5mm stereo input jack  
Contactor for battery pack  
DC Connector for power adaptor

## *Technical Parameters*

Button: Touchable interface  
Sound Pickup: heart type capacitance  
Display: OLED display 128 × 32  
Sensitivity: -46 dBV / Pa  
Maximum power consumption: 2.0W  
Directivity: 0 ° / 180 ° > 20 dB (1 kHz)  
Headphone load: 16Ω  
Headphone volume: 10mW  
Headphone jack: 3.5mm stereo  
Input impedance: 2kΩ  
SNR: 70dB  
Frequency response: 20 ~ 20000Hz  
Equivalent noise: 20dBA (SPL)  
Main material: ABS  
Operating temperature: 0 °C to + 55 °C  
Color: Black  
The maximum sound pressure: 125dB (THD ≤0.01%)  
Weight: 1.1kg (with microphone)  
Dimension: 195L × 120W × 60Hmm (without microphone)

## *Item Model for Order*

FIN-WVC-T.....Wireless Voting and interpretation Chairman unit, battery and microphone are not included  
FIN-WVD-T.....Wireless Voting and interpretation Delegate unit, battery and microphone are not included  
FIN-WBTY1.....Battery pack for each unit,8.4VDC,6600mA  
FIN-WCH1.....Charger for battery  
FIN-M220.....Pluggable Gooseneck Microphone 220mm, unique design  
FIN-M330.....330mm Microphone, with anti-wind foam cover  
FIN-M410.....410mm Microphone, with anti-wind foam cover  
FIN-M485.....485mm Microphone, with anti-wind foam cover  
FIN-M600.....600mm Microphone, with anti-wind foam cover

## PROCON Series FIN -WVCI - T/ FIN - WVDIC - T

Wireless Digital Discussion+ Voting IC Card Chairman/Delegate Unit



### Features

- Stylish, low profile design with touchable interface
- Wireless communication, setting up all system in few minutes to be ready for using, and put them away in short time as well
- 5 buttons for voting and ranking, IC card authentication will be required before voting and ranking
- Detachable battery pack is easy to replace and charge, 4 hours to fully charged. Can use 24 hours continuously, working time is 24 hours, 40 hours for standby
- Built-in DC connector for power supply without battery
- Internal high-fidelity loudspeaker
- built-in up 3 channels interpretation (optional on another model)
- Pluggable microphone and long-range sound pickup ability, support different length of microphone.
- 2.23-inch OLED display with backlight, with status of signal and battery indication icon
- Head-set interface in both sides with volume adjust
- Line-in interface which allows microphone or other line-in device like cell phone, laptop to pass audio through to perform teleconference
- Full-digital signal transmission and processing, completely avoid the RF interference from cell phone or similar devices.
- The unit showing time/date on the screen. Timer on display to set certain time for each delegate to speak, will remind user or close the MIC automatically.
- All units can be configured as Chairman or Delegate unit through software settings based on model FIN-WVCIC -T.

### Functions

- Compliance with IEC 60914, GBT 15381-94
- Standard Wi-Fi technology is compatible with other Wi-Fi networks, support 5GHz on all channels.
- Full-digital transmission and processing technology in uncompressed audio, professional microphone to achieve perfect sound quality at 20Hz ~ 20KHz;
- 128 bits digital encryption technology, with WAP2 secure connection, MAC address filtering, SSID-hiding to

prevent wiretapping and unauthorized access from delegate unit

- 8 units of delegates can open at the same time
- Support more AP working together to increasing the Wi-Fi coverage range for wireless MIC units working in a large conference room or multi-rooms
- With our HD camera and video matrix switcher, using RS485 or RS232 protocol to send the PELCO/FINCA protocol to realize camera auto-tracking function
- Precise cardioid directional microphone capsule with anti-wind microphone foam, with two-color LED indicator.
- 5 voting buttons and 1 MIC ON/OFF button, Priority & Apply Answer button for chairman unit
- Built-in high-fidelity speakers, it automatically mutes to prevent howling when press MIC ON
- Head-set interface in both sides with volume adjust
- AGC (Automatic Gain Control)/AFC (Adaptive Feedback Cancellation)/ANC (Active Noise Control)/Mix (Auto-Mix) technology
- Build-in functions for intercom
- Without using PC software, our conference controller still owns following settings:
  - Limit on the number of speaking persons: By Setting the number of active units at the same time (Number is 1/2/4/6/ units)
  - Discussion modes:  
"OPEN" Free for all, limited by the active units setting by controller, "OVERRIDE" First in First out, "VOICE" Can activate MIC by detecting sound without press button, "APPLY" To apply then to speak
  - Voting function: Approve/Abstain/Object
  - Chairman unit has priority to close all other units or mute them temporarily
  - Chairman unit can consent the request for speaking from delegate
- More voting functions available by PC software
- The unit showing real time on the screen, and count-down timer for speaking person.
- Detachable battery pack is easy to replace and charge, 4 hours to fully charged. Can use 24 hours continuously, power-saving technology to enable 24 hours continuous use and 48 hours for standby
- Combined with camera and camera tracking controller, it has an automatic camera tracking function.
- With 2.5mm adapter power supply interface, used for emergency power supply.
- Built-in MCU, support wireless upgrade of all units.
- With voice control function, you can adjust the sensitivity of voice control, intelligently turn on the microphone and set the off time.

## Control & Indicators

**Microphone with two-color LED ring, red indicates speaking status, green indicates request to speak.**

128x32 OLED display with volume bar, clock, time span of microphone activating, MIC ON/OFF etc. and other information.

Indicator for Volume adjustment

5 voting keys with indicators, while no launching voting, no.2 and no.3 button is also work as channel selecting buttons, no.4 and no.5 work as volume buttons.

Indicator for MIC ON/OFF

Chairman unit with priority button and consent button for the delegates

Power ON/OFF button is hiding on the left side



## Interfaces

Pluggable gooseneck microphone base  
2x 3.5mm stereo headphone jack  
1x 3.5mm stereo input jack  
Contactor for battery pack  
DC Connector for power adaptor

## Technical Parameters

Button: Touchable interface  
Sound Pickup: heart type capacitance  
Display: OLED display 128 × 32  
Sensitivity: -46 dBV / Pa  
Maximum power consumption: 2.0W  
Directivity: 0 ° / 180 ° > 20 dB (1 kHz)  
Headphone load: 16Ω  
Headphone volume: 10mW  
Headphone jack: 3.5mm stereo  
Input impedance: 2kΩ  
SNR: 70dB  
Frequency response: 20 ~ 20000Hz  
Equivalent noise: 20dBA (SPL)  
Main material: ABS  
Operating temperature: 0 °C to + 55 °C  
Color: Black  
The maximum sound pressure: 125dB (THD ≤0.01%)  
Weight: 1.1kg (with microphone)  
Dimension: 195L × 120W × 60Hmm (without microphone)

## Item Model for Order

FIN-WVCIC-T.....Wireless Digital Discussion+ Voting IC Card Chairman unit, battery and microphone are not included  
FIN-WVDIC-T.....Wireless Digital Discussion+ Voting IC Card Delegate unit, battery and microphone are not included  
FIN-CARDWR.....Card writer to support import information on the IC card, USB connection to PC  
FIN-WBTY1.....Battery pack for each unit,8.4VDC,6600mA  
FIN-WCH1.....Charger for battery  
FIN-M220.....Pluggable Gooseneck Microphone 220mm, unique design  
FIN-M330.....330mm Microphone, with anti-wind foam cover  
FIN-M410.....410mm Microphone, with anti-wind foam cover  
FIN-M485.....485mm Microphone, with anti-wind foam cover  
FIN-M600.....600mm Microphone, with anti-wind foam cover

## Contactless IC card



### *Features*

- Proven, Reliable Technology - Offers extremely consistent read range
- Fast Processing and Data Communication
- True Credit Card Thickness

### *Technical Parameters*

Dimensions: 2.125 x 3.375x .03" (5.4 x 8.57 x 0.076 cm)

Weight: 6g

Typical Maximum Read Range: Up to 4" (10cm)

Operating Frequency: 13.56MHz

RF Interface: ISO/IEC 14443A/MIFARE, Parts 1-3

Transaction Time: < 100ms

Baud Rate: 106 kbps

Data Retention: 10 years min.

## PROCON Series FIN - WSC - T/ FIN - WSD - T

Wireless Digital Dual Selectors Chairman/Delegate Unit



### Features

- Stylish, low profile design with touchable interface
- Wireless communication, setting up all system in few minutes to be ready for using, and put them away in short time as well
- Detachable battery pack is easy to replace and charge, 4 hours to fully charged. Can use 24 hours continuously
- Built-in DC connector for power supply without battery
- Internal high-fidelity loudspeaker
- Dual Interpretation Selectors
- Built-in up 8 channels interpretation for each selector
- Pluggable microphone and long range sound pickup ability, support different length of microphone.
- 2.23-inch OLED display with backlight, with status of signal and battery indication icon
- Head-set interface in both sides with volume adjust
- Line-in interface which allows microphone or other line-in device like cell phone, laptop to pass audio through to perform teleconference
- Full-digital signal transmission and processing, completely avoid the RF interference from cell phone or similar devices.
- The unit showing time/date on the screen. Timer on display to set certain time for each delegate to speak, will remind user or close the MIC automatically.
- All units can be configured as Chairman or Delegate unit through software settings based on model FIN-WSC -T.

### Functions

- Compliance with IEC 60914, GBT 15381-94
- Standard Wi-Fi technology is compatible with other Wi-Fi networks, support 2.4GHz and 5GHz on all channels.
- Full-digital transmission and processing technology in uncompressed audio, professional microphone to achieve perfect sound quality at 20Hz ~ 20KHz;
- 128 bits digital encryption technology, with WAP2 secure connection, MAC address filtering, SSID-hiding to

prevent wiretapping and unauthorized access from delegate unit

- 8 units of delegates can open at the same time
- Support more AP working together to increasing the Wi-Fi coverage range for wireless MIC units working in a large conference room or multi-rooms
- With our HD camera and video matrix switcher, using RS485 or RS232 protocol to send the PELCO/ FINCA protocol to realize camera auto-tracking function
- Precise cardioid directional microphone capsule with anti-wind microphone foam, with two-color LED indicator.
- 2 channels selectors and 1 MIC ON/OFF button, Priority & Apply Answer button for chairman unit
- Built-in high-fidelity speakers, it automatically mutes to prevent howling when press MIC ON
- Head-set interface in both sides with volume adjust
- AGC (Automatic Gain Control)/AFC (Adaptive Feedback Cancellation)/ANC (Active Noise Control)/Mix (Auto-Mix) technology
- Build-in functions for intercom
- Without using PC software, our conference controller still owns following settings:
  - Limit on the number of speaking persons: By Setting the number of active units at the same time (Number is 1/2/4/6/ units)
  - Discussion modes:  
"OPEN" Free for all, limited by the active units setting by controller, "OVERRIDE" First in First out, "VOICE" Can activate MIC by detecting sound without press button, "APPLY" To apply then to speak
    - Chairman unit has priority to close all other units or mute them temporarily
    - Chairman unit can consent the request for speaking from delegate
- More voting functions available by PC software
- The unit showing real time on the screen, and count-down timer for speaking person.
- Detachable battery pack is easy to replace and charge, 4 hours to fully charged. Can use 24 hours continuously, power-saving technology to enable 24 hours continuous use and 48 hours for standby
- Combined with camera and camera tracking controller, it has an automatic camera tracking function.
- With 2.5mm adapter power supply interface, used for emergency power supply.
- Built-in MCU, support wireless upgrade of all units.
- With voice control function, you can adjust the sensitivity of voice control, intelligently turn on the microphone and set the off time.

## Control & Indicators

Microphone with two-color LED ring, red indicates speaking status, green indicates request to speak.

128x32 OLED display with volume bar, clock, time span of microphone activating, MIC ON/OFF etc. and other information.

Indicator for Volume adjustment

2 groups of channels selector buttons

Indicator for MIC ON/OFF

Chairman unit with priority button and consent button for the delegates

Power ON/OFF button is hiding on the left side

## *Interfaces*

Pluggable gooseneck microphone base  
2x 3.5mm stereo headphone jack  
1x 3.5mm stereo input jack  
Contactor for battery pack  
DC Connector for power adaptor

## *Technical Parameters*

Button: Touchable interface  
Sound Pickup: heart type capacitance  
Display: OLED display 128 × 32  
Sensitivity: -46 dBV / Pa  
Maximum power consumption: 2.0W  
Directivity: 0 ° / 180 ° > 20 dB (1 kHz)  
Headphone load: 16Ω  
Headphone volume: 10mW  
Headphone jack: 3.5mm stereo  
Input impedance: 2kΩ  
SNR: 70dB  
Frequency response: 20 ~ 20000Hz  
Equivalent noise: 20dBA (SPL)  
Main material: ABS  
Operating temperature: 0 °C to + 55 °C  
Color: Black  
The maximum sound pressure: 125dB (THD ≤0.01%)  
Weight: 1.1kg (with microphone)  
Dimension: 195L × 120W × 60Hmm (without microphone)

## *Item Model for Order*

FIN-WSC-T..... Wireless Dual Channels Chairman unit, battery and microphone are not included  
FIN-WSD-T..... Wireless Dual Channels Delegate unit, battery and microphone are not included  
FIN-M220..... Pluggable Gooseneck Microphone 220mm, unique design  
FIN-M330..... 330mm Microphone, with anti-wind foam cover  
FIN-M410..... 410mm Microphone, with anti-wind foam cover  
FIN-M485..... 485mm Microphone, with anti-wind foam cover  
FIN-M600..... 600mm Microphone, with anti-wind foam cover

## FIN-AP4C

2.4GHz/5.4GHz Conference Access Point



### Features

- Connect with the Wi-fi conference processor FIN-DCP2000-W, or with the switch to extend more conference AP in the same system. Open Media Control Protocol over Ethernet supported.
- Typical coverage range 30m. Permanent malfunction monitoring and error diagnostics
- Each AP can connect up to 50 conference units.
- With scan and diagnose function , Electronically balanced XLR In and Output
- Install on ceiling, wall or with stand rack mount
- 128 bits AES digital encryption technology, with WAP2 secure connection, MAC address filtering, SSID-hiding to prevent wiretapping and unauthorized access from delegate unit

### Functions

- LED indicator for signal/power
- 5GHz dual band communication
- LAN support POE power supply
- RJ45 for LAN connection

### Technical Parameters

RF	
WLAN Standard	IEEE802.11ac, IEEE802.11a, IEEE802.11g, IEEE802.11b
RF Frequency Bands	2.4GHz ISM / 5.4GHz UNII
RF output power	64mW
Frequency response	80-15kHz
Max Transmission Power	27dBm
Antenna Type	Four built-in 5dBi omnidirectional antennas

# finetune

Full Digital Networked DSP Conference System

<b>POWER</b>	
Supply Type	Power Over Ethernet, 802.3at, DC 12V 1.5A
Supply Voltage(at Power Consumption)	≤13W
<b>NETWORK</b>	
Interface	1×Gigabit WAN/POE Port, 1×Gigabit LAN Port
Link Speed	1200Mbps
Networking Addressing Capability	DHCP or Manual IP address
Cable Length	100m (max)
Cable Type	≥ Cat5e (shielded / unshielded)
Connector Type	1× RJ45
Connector LED	WAN/POE Port (UP LED), LAN Port (Down LED)
<b>USER INTERFACE</b>	
LED Status Indication	Power, Network Audio, Wireless (Yellow / Blue)
Reset	Push button for Factory Reset
<b>MECHANICAL</b>	
Dimensions	220L×220W×45H(mm)
Color	White
Weight	0.3KG
Mounting Type	Ceiling, Wall or Stand Rack

## *Item Model for Order*

FIN-AP4C..... 2.4GHz/5.4GHz Conference Access point (white)

## FIN-WBTY1

Rechargeable Battery pack for wireless unit



### *Features*

- Long life and lasting stability of charging performance
- After fully charged it can use 24 hours
- Four hours needed to fully charge
- Efficient lithium batteries

### *Functions*

Contacting by pop-up pins

Buckle housing to prevent poor contact or dropping

### *Technical Parameters*

Battery capacity: 4900mAh

Output voltage: 7.2VDC

Weight: 285g

Operation temperature: -20°C~60°C

### *Item Model for Order*

FIN-WBTY1..... Battery pack for wireless units,4900mAh 7.2VDC

FIN-WCH1..... Charger for battery,10pcs FIN-WBTY1 at one time



## FIN-WCH1

Charger for battery



### Features

- Three hours needed to fully charge
- MAX 8 pcs battery charging at one time
- Wide range power input: 100V~240V AC
- Buckle housing to prevent poor contact or dropping, light in weight for easy moving

### Functions

Contacting by pop-up pins

Buckle housing to prevent poor contact or dropping

### Technical Parameters

Input: 100 ~ 240VAC 50 ~ 60HZ

Output: 7.2V/1000mA

Power consumption: 150W

Size: 320Lx200Wx50H(mm)

Weight: 2KG

### Item Model for Order

FIN-WBTY1..... Battery pack for wireless units, 4900mA 7.2V DC

FIN-WCH1..... Charger for battery, 8 pcs FIN-WBTY1 at one time

## FIN-CNB

Splitter box



### *Features*

- No noise design
- Compact size
- Splitting two channels for CU/DU

### *Functions*

- To achieve loop wired architecture with star-type wired benefits
- Repeat 2 CU/DU channels for reducing the cables and different project requirements.
- No noise working design

### *Interfaces*

2 x RJ45 loop ports and 2 xRJ45 for repeated chains ports

### *Technical Parameters*

Dimension:80Lx50Wx23Hmm

Weigth:0.1KG

### *Item Model for Order*

FIN-CNB..... Splitter box

## FIN - M600 / FIN - M - 485 / FIN -M410 / FIN - M330 / FIN - M220

Pluggable Gooseneck Microphone



### Features

- Precise directional microphone head with Mini design
- Two color LED ring indicator
- anti-wind microphone foam cover
- Strong audio collection ability to work with different length of microphone

### Functions

- Two-color LED indicator on microphone, red for speaking, green means need acceptance from chairman to speak
- Screw lock socket to connect removable microphone

### Technical Parameters

Item	FIN - M600	FIN - M - 485	FIN - M410	FIN - M330	FIN - M220
Directivity	Cardioid				
Sensitivity	-46dBV/Pa				
Frequency response	30Hz~20KHz				
Equivalent noise	20dBA (SPL)				
Signal-To-Noise Ratio Ref	≥96dB				
Microphone Type	Condenser				
Maximum SPL (1 kHz at 1% THD, 1 kΩ load)	125dB ( THD<3% )				
Conference unit connection	Mini 6 pin.				
Input impedance	2 kΩ				

Working temperature	0~45°C				
Storage temperature	-20~50°C				
Weight	80g	80g	60g	60g	60g
Length	600mm	485mm	410mm	330mm	220mm
Color	black				

### *Item Model for Order*

FIN-M220.....Pluggable Gooseneck Microphone 220mm, unique design

FIN-M330.....330mm Microphone, with anti-wind foam cover

FIN-M410.....410mm Microphone, with anti-wind foam cover

FIN-M485.....485mm Microphone, with anti-wind foam cover

FIN-M600.....600mm Microphone, with anti-wind foam cover

## **About Finetune Pro-Audio Inc.**

Our mission is to develop and manufacture the most comprehensive and innovative audio visual products for our clients. We provide the best performance/price ratio products because it could give you satisfaction just from the time you use them, we believe the good design with cutting edge technology on products will provide value to all our partners and end users. Listen to your demands, we fulfill it.

# **finetune**

**Finetune Pro-Audio (Inc) Headquarters 817 Zaininger Ave  
Naperville, Illinois IL 60563 United States**

Authorized Distributor in APAC: Technify Solutions, #29-71 Block 19, Cantonment Tower,  
Cantonment Close, Singapore 080019 [info@technify.co.in](mailto:info@technify.co.in)

[info@finetune.pro](mailto:info@finetune.pro)

**Finetune Pro-Audio Inc.**